

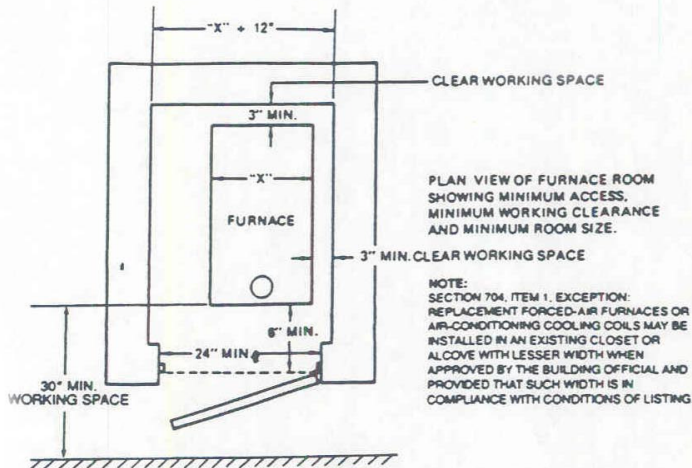

CLEARANCES

**2007
CA MECHANICAL CODE
904.2 & 305.0**

TABLE 9-1



PLAN VIEW OF FURNACE ROOM
SHOWING MINIMUM ACCESS,
MINIMUM WORKING CLEARANCE
AND MINIMUM ROOM SIZE.

NOTE:
SECTION 704, ITEM 1. EXCEPTION:
REPLACEMENT FORCED-AIR FURNACES OR
AIR-CONDITIONING COOLING COILS MAY BE
INSTALLED IN AN EXISTING CLOSET OR
ALCOVE WITH LESSER WIDTH WHEN
APPROVED BY THE BUILDING OFFICIAL AND
PROVIDED THAT SUCH WIDTH IS IN
COMPLIANCE WITH CONDITIONS OF LISTING.

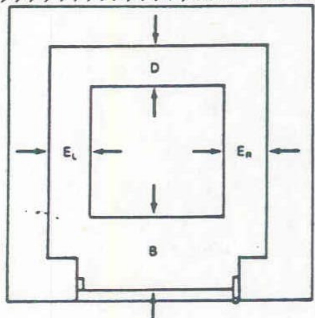

EXAMPLE OF LISTING INFORMATION

PLAN VIEW

MODEL FGZ-2	A	B	C	D	E _L	E _R	F	INPUT
	1'	6"	6"	0'	0"	0"	C	80,000

- A. CLEARANCE ABOVE BONNET
- C. CLEARANCE FROM FLUE OR VENT CONNECTOR IN ANY DIRECTION
- F. TYPE OF FLOOR ("C" = COMBUSTIBLE, "NC" = NONCOMBUSTIBLE)

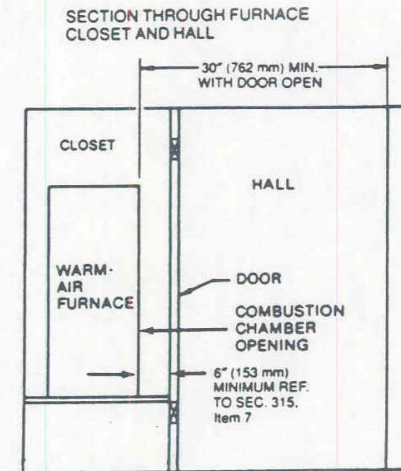

NOTE: WORKING SPACE
REQUIREMENTS SHALL BE
MAINTAINED AS REQUIRED
IN OTHER SECTIONS OF
THE CODE.

REQUIRED MINIMUM CLEARANCE
ON ALL SIDES AND FRONT PER
MANUFACTURER'S INSTALLATION
INSTRUCTIONS.

ENCLOSURE DOOR WIDE
ENOUGH TO PERMIT REMOVAL
OR REPLACEMENT AND SERVICING,
BUT MINIMUM 24" (610 mm) WIDE
FOR HEATING EQUIPMENT.
(REFER TO SECTION 314.)

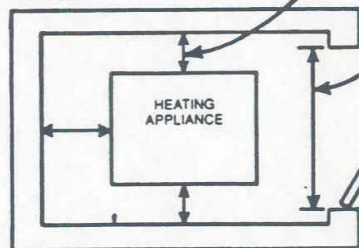

PLAN VIEW