

# REPORT

To the Honorable Mayor and City Council  
From the City Manager

August 13, 2007

## SUBJECT

Award of Contract -- Redwood City Recycled Water Project -- Phase I -- Seaport Distribution System -- Bid Package 5 (Seaport Boulevard, Seaport Court, Chesapeake Drive & Herkner Road) Project

## RECOMMENDATION

Approve, by motion, the contract documents and award the contract for the Redwood City Recycled Water Project -- Phase I -- Seaport Distribution System -- Bid Package 5 (Seaport Boulevard, Seaport Court, Chesapeake Drive & Herkner Road) Project to the lowest responsible bidder, Shaw Pipeline, Inc. of San Francisco, California, for their low bid of \$ 2,104,800.00.

## BACKGROUND

In August 2003, the City Council approved a broadly defined, flexible project, filed a California Environmental Quality Act Notice of Determination, and formed a citizen community task force to provide input on the implementation of the project. In March 2004, the City Council accepted the Task Force Report and directed staff to return with various implementation actions for their consideration.

The Redwood City Recycled Water Project will be implemented in phases and smaller, discrete projects over the next several years, beginning with some recycled water delivery in the 2007 irrigation season. The major components of the Project are:

1. Treatment improvements consisting of filter modifications, chemical feed addition and filtered water line at the SBSA site -- owned and operated by South Bayside System Authority (SBSA). Status: 100% complete and in service.
2. Disinfection facility consisting of new chlorine contact chambers at the SBSA site -- owned by the City and operated by SBSA. Status: 100% complete and in service.
3. Storage and pumping facilities located within the SBSA plant property (includes a back-up supply line for potable water) -- owned and operated by the City. Status: 100% complete and in service.
4. Distribution system consisting of new transmission pipelines throughout the water service area, in street rights-of-ways -- owned and operated by the City. Status: The first and second projects (Bid Packages 1 and 2) are 95% and 100% constructed, respectively. Bid Package 3 is also 95% completed. Bid Package 4 is under construction with 60% of the work to go, and scheduled for completion by the end of this year.
5. Customer site retrofits for each existing private or public site with a landscape irrigation meter. Retrofits will occur as each property owner agrees to convert to recycled water for landscape irrigation and industrial uses. Status: The first

Customer Site Retrofit package (Retrofit Bid Package 1) for 18 commercial sites in the Redwood Shores area are under construction for the 2007 irrigation season. Construction is 70% completed.

This pipeline construction project (Bid Package 5 – see attached map) is the fifth distribution system project designed to extend the delivery of recycled water to the Seaport area. The completion of Bid 4 construction at the end of 2007 and the beginning of Bid 5 construction marks an important milestone in the Recycled Water Transmission System component of the project as recycled water services in Redwood Shores commence, and delivery of recycled water to commercial and industrial customers in the Bay Front and Seaport areas become the primary focus. This project consists of the installation of the main transmission piping system in Seaport Distribution System along Seaport Boulevard, Seaport Court, Chesapeake Drive & Herkner Road. More than 8,000 linear feet of PVC pipe ranging in size from 8 to 14 inches in diameter, will be constructed in approximately eight months.

The 11 bids received at the bid opening on July 25, 2007, are summarized below:

No.	Bidder	Bid Amount
1.	<b>Shaw Pipeline, Inc., San Francisco</b>	<b>\$2,104,800.00</b>
2.	D W Young Construction, Alamo	\$2,252,465.00
3.	Ranger Pipelines, San Francisco	\$2,419,680.00
4.	KJ Woods, San Francisco	\$2,474,000.00
5.	Mitchell Engineering, San Francisco	\$2,590,250.00
6.	Marques Pipeline, Inc., Sacramento	\$2,599,350.00
7.	Pacific Underground Construction, Inc., San Jose	\$2,751,260.00
8.	JMB Construction, Inc., South San Francisco	\$2,791,500.00
9.	Mountain Cascade, Inc., Livermore	\$2,858,875.00
10.	Precision Engineering, Inc., San Francisco	\$2,987,700.00
11.	West Valley Construction Company, Inc., San Jose	\$3,821,115.00

The low bid of \$2,104,800.00 from Shaw Pipeline, Inc. is 25% lower than the Engineer's estimate of \$2.8 million for the cost of construction. Based upon the bids received, staff believes that the low bid of \$2,104,800.00 is reasonable and responsive, and recommends awarding the contract to Shaw Pipeline, Inc.

#### **ALTERNATIVES**

Do not award the contract for the Redwood City Recycled Water Project – Phase I – Seaport Distribution System – Bid Package 5 (Seaport Boulevard, Seaport Court, Chesapeake Drive & Herkner Road) Project, which would be contrary to prior Council action.

#### **FISCAL IMPACT**

Funds for the proposed construction contract are available from the Water Revenue Bond proceeds. The City has issued a series of three Water Revenue Bonds to finance Phase 1 of the Recycled Water Project. Available project funds, less unattributed interest, total \$18,053,802 as of June 30, 2007.



---

Phong Du, P.E.  
Senior Civil Engineer



---

Chu Chang, P.E.  
Manager, Engineering & Construction

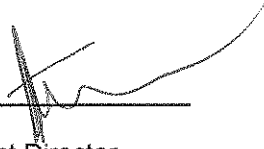

---

Peter Ingram  
Community Development Director

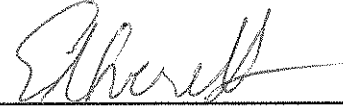

---

Ed Everett  
City Manager

**ATTACHMENTS**

Redwood City Recycled Water Program Distribution System Maps

**RELATED DOCUMENTS IN CITY CLERK'S OFFICE**

1. Contract Documents
2. Bid Documents

**THIS PAGE HAS BEEN LEFT BLANK**

**WATER RECYCLING GRANT APPLICATION  
REDWOOD CITY  
RECYCLED WATER PROJECT  
WRFP PROJECT # 3209-030**

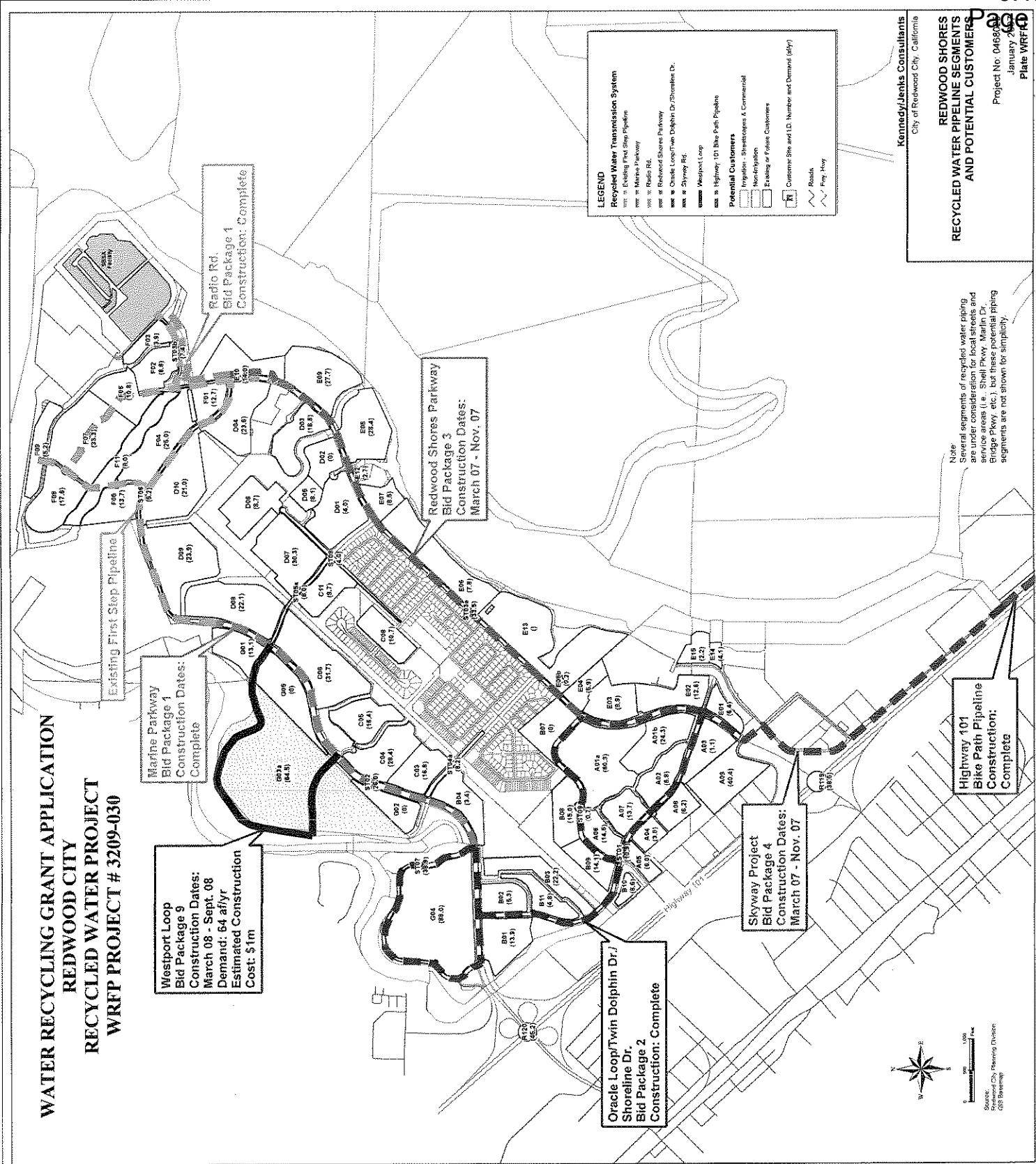

**LEGEND**

**Recycled Water Transmission System**

- Existing First Step Pipeline
- New to Marine Parkway
- New to Radio Rd.
- New to Redwood Shores Parkway
- New to Oracle Loop/Twin Dolphin Dr./Shoreline Dr.
- New to Skyway Rd.
- Midlevel Loop

**Potential Customers**

- Highway 101 Bike Path Pipeline
- Highway 92
- Highway 94
- Highway 96
- Highway 98
- Highway 101
- Highway 102
- Highway 104
- Highway 106
- Highway 108
- Highway 110
- Highway 112
- Highway 114
- Highway 116
- Highway 118
- Highway 120
- Highway 122
- Highway 124
- Highway 126
- Highway 128
- Highway 130
- Highway 132
- Highway 134
- Highway 136
- Highway 138
- Highway 140
- Highway 142
- Highway 144
- Highway 146
- Highway 148
- Highway 150
- Highway 152
- Highway 154
- Highway 156
- Highway 158
- Highway 160
- Highway 162
- Highway 164
- Highway 166
- Highway 168
- Highway 170
- Highway 172
- Highway 174
- Highway 176
- Highway 178
- Highway 180
- Highway 182
- Highway 184
- Highway 186
- Highway 188
- Highway 190
- Highway 192
- Highway 194
- Highway 196
- Highway 198
- Highway 200

**Other Symbols:**

- Customer Site and I.D. Number and Demand (sf/yr)
- Roads
- Flow Arrows

**Kennedy/Jenks Consultants**  
City of Redwood City, California

**REDWOOD SHORES  
RECYCLED WATER PIPELINE SEGMENTS  
AND POTENTIAL CUSTOMERS**

Project No: 0468000  
January 2009  
Plate WRF# 05

**Note**  
Several segments of recycled water piping are under consideration for local streets and service areas (i.e. Shell Pkwy, Martin Dr, Bridge Pkwy, etc.) but these particular piping segments are not shown for simplicity.

**Westport Loop  
Bid Package 9  
Construction Dates:  
March 08 - Sept. 08  
Demand: 64 sf/yr  
Estimated Construction  
Cost: \$1m**

**Marine Parkway  
Bid Package 1  
Construction Dates:  
Complete**

**Redwood Shores Parkway  
Bid Package 3  
Construction Dates:  
March 07 - Nov. 07**

**Skyway Project  
Bid Package 4  
Construction Dates:  
March 07 - Nov. 07**

**Highway 101  
Bike Path Pipeline  
Construction:  
Complete**

**Oracle Loop/Twin Dolphin Dr./  
Shoreline Dr.  
Bid Package 2  
Construction: Complete**

SITE	CUSTOMER
A01	Electronic Arts
A02	Shelter Properties
A03	Shelter Properties
A04	Macrominds
A05	Instill Corp
A06	RealNames (Speaker Properties)
A07	Provident Central Credit Union
A08	ENI Dolphin
A09	Neris Farmen
A10	One Corporation
B01	Emery Worldwide/Paragon Point
B02	Marina Park Center
B03	Dolphin Unit 2
B04	Boylek Dr. Penant Ct Island Point Park
B05	Coop Housing
B06	Coop Housing
B07	Coop Housing
B08	Coop Housing
B09	Coop Housing
B10	Executive Guild (Washshore Office Park)
B11	San Mateo County Office of Education
B12	Dolphin Park
C01	Starboard Park
C02	Starboard Park
C03	Pacific Cove HOA
C04	Pacific Cove HOA
C05	Shorebird Island HOA
C06	Shorebird Island HOA
C07	Beacon Shores HOA #1 & #2
C08	Beacon Shores HOA #1 & #2
C09	Seabridge Community Association
C10	Harbor Colony
C11	Main Subdivision Lots #1 & #6
C12	Aggressive Cove HOA
C13	Marina Park
C14	Shorebird Park
D01	David Lane Parcel
D02	Redwood Shores Agis
D03	Herbsterie Agis
D04	Regatta HOA
D05	Starboard Bay HOA #1 & #2
D06	Starboard Bay HOA #1 & #2
D07	Ventura Pal Mar HOA #1 & #2
D08	Lakeshore Townhomes #1 & #2
D09	Laguna Pointe HOA
D10	Harbor Court HOA
D11	The Shores HOA
D12	Sandridge School Park
D13	Shannon Park
D14	Shannon Park
D15	Pacific Athletic Club (Western)
D16	Market Place
D17	Hastings HOA
D18	Hastings HOA
D19	Terete Dr. Park
D20	Terete Dr. Park
D21	Sunrise HOA #1
D22	Sunrise HOA #1
D23	Sandridge Lagoon HOA #1
D24	Sandridge Lagoon HOA #1
D25	Bridgeport HOA
D26	Bridgeport HOA
D27	Govemor's Bay HOA
D28	Govemor's Bay HOA
D29	Mariner Park
D30	Fire Station #20
D31	Marlin Subdivision Units #2 & #2a
D32	Marlin Subdivision Units #2 & #2a
D33	Marlin Subdivision Units #2 & #2a
D34	Marlin Subdivision Units #2 & #2a
D35	Marlin Subdivision Units #2 & #2a
D36	Marlin Subdivision Units #2 & #2a
D37	Marlin Subdivision Units #2 & #2a
D38	Marlin Subdivision Units #2 & #2a
D39	Marlin Subdivision Units #2 & #2a
D40	Marlin Subdivision Units #2 & #2a
D41	Marlin Subdivision Units #2 & #2a
D42	Marlin Subdivision Units #2 & #2a
D43	Marlin Subdivision Units #2 & #2a
D44	Marlin Subdivision Units #2 & #2a
D45	Marlin Subdivision Units #2 & #2a
D46	Marlin Subdivision Units #2 & #2a
D47	Marlin Subdivision Units #2 & #2a
D48	Marlin Subdivision Units #2 & #2a
D49	Marlin Subdivision Units #2 & #2a
D50	Marlin Subdivision Units #2 & #2a
D51	Marlin Subdivision Units #2 & #2a
D52	Marlin Subdivision Units #2 & #2a
D53	Marlin Subdivision Units #2 & #2a
D54	Marlin Subdivision Units #2 & #2a
D55	Marlin Subdivision Units #2 & #2a
D56	Marlin Subdivision Units #2 & #2a
D57	Marlin Subdivision Units #2 & #2a
D58	Marlin Subdivision Units #2 & #2a
D59	Marlin Subdivision Units #2 & #2a
D60	Marlin Subdivision Units #2 & #2a
D61	Marlin Subdivision Units #2 & #2a
D62	Marlin Subdivision Units #2 & #2a
D63	Marlin Subdivision Units #2 & #2a
D64	Marlin Subdivision Units #2 & #2a
D65	Marlin Subdivision Units #2 & #2a
D66	Marlin Subdivision Units #2 & #2a
D67	Marlin Subdivision Units #2 & #2a
D68	Marlin Subdivision Units #2 & #2a
D69	Marlin Subdivision Units #2 & #2a
D70	Marlin Subdivision Units #2 & #2a
D71	Marlin Subdivision Units #2 & #2a
D72	Marlin Subdivision Units #2 & #2a
D73	Marlin Subdivision Units #2 & #2a
D74	Marlin Subdivision Units #2 & #2a
D75	Marlin Subdivision Units #2 & #2a
D76	Marlin Subdivision Units #2 & #2a
D77	Marlin Subdivision Units #2 & #2a
D78	Marlin Subdivision Units #2 & #2a
D79	Marlin Subdivision Units #2 & #2a
D80	Marlin Subdivision Units #2 & #2a
D81	Marlin Subdivision Units #2 & #2a
D82	Marlin Subdivision Units #2 & #2a
D83	Marlin Subdivision Units #2 & #2a
D84	Marlin Subdivision Units #2 & #2a
D85	Marlin Subdivision Units #2 & #2a
D86	Marlin Subdivision Units #2 & #2a
D87	Marlin Subdivision Units #2 & #2a
D88	Marlin Subdivision Units #2 & #2a
D89	Marlin Subdivision Units #2 & #2a
D90	Marlin Subdivision Units #2 & #2a
D91	Marlin Subdivision Units #2 & #2a
D92	Marlin Subdivision Units #2 & #2a
D93	Marlin Subdivision Units #2 & #2a
D94	Marlin Subdivision Units #2 & #2a
D95	Marlin Subdivision Units #2 & #2a
D96	Marlin Subdivision Units #2 & #2a
D97	Marlin Subdivision Units #2 & #2a
D98	Marlin Subdivision Units #2 & #2a
D99	Marlin Subdivision Units #2 & #2a
D100	Marlin Subdivision Units #2 & #2a
D101	Marlin Subdivision Units #2 & #2a
D102	Marlin Subdivision Units #2 & #2a
D103	Marlin Subdivision Units #2 & #2a
D104	Marlin Subdivision Units #2 & #2a
D105	Marlin Subdivision Units #2 & #2a
D106	Marlin Subdivision Units #2 & #2a
D107	Marlin Subdivision Units #2 & #2a
D108	Marlin Subdivision Units #2 & #2a
D109	Marlin Subdivision Units #2 & #2a
D110	Marlin Subdivision Units #2 & #2a
D111	Marlin Subdivision Units #2 & #2a
D112	Marlin Subdivision Units #2 & #2a
D113	Marlin Subdivision Units #2 & #2a
D114	Marlin Subdivision Units #2 & #2a
D115	Marlin Subdivision Units #2 & #2a
D116	Marlin Subdivision Units #2 & #2a
D117	Marlin Subdivision Units #2 & #2a
D118	Marlin Subdivision Units #2 & #2a
D119	Marlin Subdivision Units #2 & #2a
D120	Marlin Subdivision Units #2 & #2a
D121	Marlin Subdivision Units #2 & #2a
D122	Marlin Subdivision Units #2 & #2a
D123	Marlin Subdivision Units #2 & #2a
D124	Marlin Subdivision Units #2 & #2a
D125	Marlin Subdivision Units #2 & #2a
D126	Marlin Subdivision Units #2 & #2a
D127	Marlin Subdivision Units #2 & #2a
D128	Marlin Subdivision Units #2 & #2a
D129	Marlin Subdivision Units #2 & #2a
D130	Marlin Subdivision Units #2 & #2a
D131	Marlin Subdivision Units #2 & #2a
D132	Marlin Subdivision Units #2 & #2a
D133	Marlin Subdivision Units #2 & #2a
D134	Marlin Subdivision Units #2 & #2a
D135	Marlin Subdivision Units #2 & #2a
D136	Marlin Subdivision Units #2 & #2a
D137	Marlin Subdivision Units #2 & #2a
D138	Marlin Subdivision Units #2 & #2a
D139	Marlin Subdivision Units #2 & #2a
D140	Marlin Subdivision Units #2 & #2a
D141	Marlin Subdivision Units #2 & #2a
D142	Marlin Subdivision Units #2 & #2a
D143	Marlin Subdivision Units #2 & #2a
D144	Marlin Subdivision Units #2 & #2a
D145	Marlin Subdivision Units #2 & #2a
D146	Marlin Subdivision Units #2 & #2a
D147	Marlin Subdivision Units #2 & #2a
D148	Marlin Subdivision Units #2 & #2a
D149	Marlin Subdivision Units #2 & #2a
D150	Marlin Subdivision Units #2 & #2a
D151	Marlin Subdivision Units #2 & #2a
D152	Marlin Subdivision Units #2 & #2a
D153	Marlin Subdivision Units #2 & #2a
D154	Marlin Subdivision Units #2 & #2a
D155	Marlin Subdivision Units #2 & #2a
D156	Marlin Subdivision Units #2 & #2a
D157	Marlin Subdivision Units #2 & #2a
D158	Marlin Subdivision Units #2 & #2a
D159	Marlin Subdivision Units #2 & #2a
D160	Marlin Subdivision Units #2 & #2a
D161	Marlin Subdivision Units #2 & #2a
D162	Marlin Subdivision Units #2 & #2a
D163	Marlin Subdivision Units #2 & #2a
D164	Marlin Subdivision Units #2 & #2a
D165	Marlin Subdivision Units #2 & #2a
D166	Marlin Subdivision Units #2 & #2a
D167	Marlin Subdivision Units #2 & #2a
D168	Marlin Subdivision Units #2 & #2a
D169	Marlin Subdivision Units #2 & #2a
D170	Marlin Subdivision Units #2 & #2a
D171	Marlin Subdivision Units #2 & #2a
D172	Marlin Subdivision Units #2 & #2a
D173	Marlin Subdivision Units #2 & #2a
D174	Marlin Subdivision Units #2 & #2a
D175	Marlin Subdivision Units #2 & #2a
D176	Marlin Subdivision Units #2 & #2a
D177	Marlin Subdivision Units #2 & #2a
D178	Marlin Subdivision Units #2 & #2a
D179	Marlin Subdivision Units #2 & #2a
D180	Marlin Subdivision Units #2 & #2a
D181	Marlin Subdivision Units #2 & #2a
D182	Marlin Subdivision Units #2 & #2a
D183	Marlin Subdivision Units #2 & #2a
D184	Marlin Subdivision Units #2 & #2a
D185	Marlin Subdivision Units #2 & #2a
D186	Marlin Subdivision Units #2 & #2a
D187	Marlin Subdivision Units #2 & #2a
D188	Marlin Subdivision Units #2 & #2a
D189	Marlin Subdivision Units #2 & #2a
D190	Marlin Subdivision Units #2 & #2a
D191	Marlin Subdivision Units #2 & #2a
D192	Marlin Subdivision Units #2 & #2a
D193	Marlin Subdivision Units #2 & #2a
D194	Marlin Subdivision Units #2 & #2a
D195	Marlin Subdivision Units #2 & #2a
D196	Marlin Subdivision Units #2 & #2a
D197	Marlin Subdivision Units #2 & #2a
D198	Marlin Subdivision Units #2 & #2a
D199	Marlin Subdivision Units #2 & #2a
D200	Marlin Subdivision Units #2 & #2a
D201	Marlin Subdivision Units #2 & #2a
D202	Marlin Subdivision Units #2 & #2a
D203	Marlin Subdivision Units #2 & #2a
D204	Marlin Subdivision Units #2 & #2a
D205	Marlin Subdivision Units #2 & #2a
D206	Marlin Subdivision Units #2 & #2a
D207	Marlin Subdivision Units #2 & #2a
D208	Marlin Subdivision Units #2 & #2a
D209	Marlin Subdivision Units #2 & #2a
D210	Marlin Subdivision Units #2 & #2a
D211	Marlin Subdivision Units #2 & #2a
D212	Marlin Subdivision Units #2 & #2a
D213	Marlin Subdivision Units #2 & #2a
D214	Marlin Subdivision Units #2 & #2a
D215	Marlin Subdivision Units #2 & #2a
D216	Marlin Subdivision Units #2 & #2a
D217	Marlin Subdivision Units #2 & #2a
D218	Marlin Subdivision Units #2 & #2a
D219	Marlin Subdivision Units #2 & #2a
D220	Marlin Subdivision Units #2 & #2a
D221	Marlin Subdivision Units #2 & #2a
D222	Marlin Subdivision Units #2 & #2a
D223	Marlin Subdivision Units #2 & #2a
D224	Marlin Subdivision Units #2 & #2a
D225	Marlin Subdivision Units #2 & #2a
D226	Marlin Subdivision Units #2 & #2a
D227	Marlin Subdivision Units #2 & #2a
D228	Marlin Subdivision Units #2 & #2a
D229	Marlin Subdivision Units #2 & #2a
D230	Marlin Subdivision Units #2 & #2a
D231	Marlin Subdivision Units #2 & #2a
D232	Marlin Subdivision Units #2 & #2a
D233	Marlin Subdivision Units #2 & #2a
D234	Marlin Subdivision Units #2 & #2a
D235	Marlin Subdivision Units #2 & #2a
D236	Marlin Subdivision Units #2 & #2a
D237	Marlin Subdivision Units #2 & #2a
D238	Marlin Subdivision Units #2 & #2a
D239	Marlin Subdivision Units #2 & #2a
D240	Marlin Subdivision Units #2 & #2a
D241	Marlin Subdivision Units #2 & #2a
D242	Marlin Subdivision Units #2 & #2a
D243	Marlin Subdivision Units #2 & #2a
D244	Marlin Subdivision Units #2 & #2a
D245	Marlin Subdivision Units #2 & #2a
D246	Marlin Subdivision Units #2 & #2a
D247	Marlin Subdivision Units #2 & #2a
D248	Marlin Subdivision Units #2 & #2a
D249	Marlin Subdivision Units #2 & #2a
D250	Marlin Subdivision Units #2 & #2a
D251	Marlin Subdivision Units #2 & #2a
D252	Marlin Subdivision Units #2 & #2a
D253	Marlin Subdivision Units #2 & #2a
D254	Marlin Subdivision Units #2 & #2a
D255	Marlin Subdivision Units #2 & #2a
D256	Marlin Subdivision Units #2 & #2a
D257	Marlin Subdivision Units #2 & #2a
D258	Marlin Subdivision Units #2 & #2a
D259	Marlin Subdivision Units #2 & #2a
D260	Marlin Subdivision Units #2 & #2a
D261	Marlin Subdivision Units #2 & #2a
D262	Marlin Subdivision Units #2 & #2a
D263	Marlin Subdivision Units #2 & #2a
D264	Marlin Subdivision Units #2 & #2a
D265	Marlin Subdivision Units #2 & #2a
D266	Marlin Subdivision Units #2 & #2a
D267	Marlin Subdivision Units #2 & #2a
D268	Marlin Subdivision Units #2 & #2a
D269	Marlin Subdivision Units #2 & #2a
D270	Marlin Subdivision Units #2 & #2a
D271	Marlin Subdivision Units #2 & #2a
D272	Marlin Subdivision Units #2 & #2a
D273	Marlin Subdivision Units #2 & #2a
D274	Marlin Subdivision Units #2 & #2a
D275	Marlin Subdivision Units #2 & #2a
D276	Marlin Subdivision Units #2 & #2a
D277	Marlin Subdivision Units #2 & #2a
D278	Marlin Subdivision Units #2 & #2a
D279	Marlin Subdivision Units #2 & #2a
D280	Marlin Subdivision Units #2 & #2a
D281	Marlin Subdivision Units #2 & #2a
D282	Marlin Subdivision Units #2 & #2a
D283	Marlin Subdivision Units #2 & #2a
D284	Marlin Subdivision Units #2 & #2a
D285	Marlin Subdivision Units #2 & #2a
D286	Marlin Subdivision Units #2 & #2a
D287	Marlin Subdivision Units #2 & #2a
D288	Marlin Subdivision Units #2 & #2a
D289	Marlin Subdivision Units #2 & #2a
D290	Marlin Subdivision Units #2 & #2a
D291	Marlin Subdivision Units #2 & #2a
D292	Marlin Subdivision Units #2 & #2a
D293	Marlin Subdivision Units #2 & #2a
D294	Marlin Subdivision Units #2 & #2a
D295	Marlin Subdivision Units #2 & #2a
D296	Marlin Subdivision Units #2 & #2a
D297	Marlin Subdivision Units #2 & #2a
D298	Marlin Subdivision Units #2 & #2a
D299	Marlin Subdivision Units #2 & #2a
D300	Marlin Subdivision Units #2 & #2a
D301	Marlin Subdivision Units #2 & #2a
D302	Marlin Subdivision Units #2 & #2a
D303	Marlin Subdivision Units #2 & #2a
D304	Marlin Subdivision Units #2 & #2a
D305	Marlin Subdivision Units #2 & #2a
D306	Marlin Subdivision Units #2 & #2a
D307	Marlin Subdivision Units #2 & #2a
D308	Marlin Subdivision Units #2 & #2a
D309	Marlin Subdivision Units #2 & #2a
D310	Marlin Subdivision Units #2 & #2a
D311	Marlin Subdivision Units #2 & #2a
D312	Marlin Subdivision Units #2 & #2a
D313	Marlin Subdivision Units #2 & #2a
D314	Marlin Subdivision Units #2 & #2a
D315	Marlin Subdivision Units #2 & #2a
D316	Marlin Subdivision Units #2 & #2a
D317	Marlin Subdivision Units #2 & #2a
D318	Marlin Subdivision Units #2 & #2a
D319	Marlin Subdivision Units #2 & #2a
D320	Marlin Subdivision Units #2 & #2a
D321	Marlin Subdivision Units #2 & #2a
D322	Marlin Subdivision Units #2 & #2a
D323	Marlin Subdivision Units #2 & #2a
D324	Marlin Subdivision Units #2 &

# WATER RECYCLING GRANT APPLICATION REDWOOD CITY RECYCLED WATER PROJECT WRFP PROJECT # 3209-030

Site	Customer
R01	Pacific Shores
R02	Harbor Sand & Gravel
R03	SANMETAL, America
R04	Pelco Optimum
R05	Central Concrete
R06	Central Concrete
R07	Central Concrete
R08	ROMAC Chemical
R09	Port of Redwood City Office
R10	USGS Office
R11	Basic Chemical Solutions
R12	Basic Chemical Solutions
R13	Portside Center Office
R14	Portside Center Office
R15	Seaport Plaza
R16	Seaport Center
R17	Seaport Center
R18	Seaport Center
R19	Harbor Sand & Gravel
R20	Harbor Sand & Gravel
R21	Granite Rock - Road Materials
R22	Granite Rock - Road Materials
R23	Lyngs Garden Materials
R24	Nalco Grand Prix
R25	Nalco Grand Prix
R26	Nalco Grand Prix
R27	RWC Public Facility
R28	Pelco's Harbor
R29	County Of San Mateo Sheriff
R30	Seaport Blvd Streetcapes
R31	Seaport Blvd Streetcapes
R32	Seaport Blvd Streetcapes
R33	Seaport Blvd Streetcapes
R34	Seaport Blvd Streetcapes
R35	Seaport Blvd Streetcapes
R36	Seaport Blvd Streetcapes
R37	Seaport Blvd Streetcapes
R38	Seaport Blvd Streetcapes
R39	Seaport Blvd Streetcapes
R40	Seaport Blvd Streetcapes
R41	Seaport Blvd Streetcapes
R42	Seaport Blvd Streetcapes
R43	Seaport Blvd Streetcapes
R44	Seaport Blvd Streetcapes
R45	Seaport Blvd Streetcapes
R46	Seaport Blvd Streetcapes
R47	Seaport Blvd Streetcapes
R48	Seaport Blvd Streetcapes
R49	Seaport Blvd Streetcapes
R50	Seaport Blvd Streetcapes
R51	Seaport Blvd Streetcapes
R52	Seaport Blvd Streetcapes
R53	Seaport Blvd Streetcapes
R54	Seaport Blvd Streetcapes
R55	Seaport Blvd Streetcapes
R56	Seaport Blvd Streetcapes
R57	Seaport Blvd Streetcapes
R58	Seaport Blvd Streetcapes
R59	Seaport Blvd Streetcapes
R60	Seaport Blvd Streetcapes
R61	Seaport Blvd Streetcapes
R62	Seaport Blvd Streetcapes
R63	Seaport Blvd Streetcapes
R64	Seaport Blvd Streetcapes
R65	Seaport Blvd Streetcapes
R66	Seaport Blvd Streetcapes
R67	Seaport Blvd Streetcapes
R68	Seaport Blvd Streetcapes
R69	Seaport Blvd Streetcapes
R70	Seaport Blvd Streetcapes
R71	Seaport Blvd Streetcapes
R72	Seaport Blvd Streetcapes
R73	Seaport Blvd Streetcapes
R74	Seaport Blvd Streetcapes
R75	Seaport Blvd Streetcapes
R76	Seaport Blvd Streetcapes
R77	Seaport Blvd Streetcapes
R78	Seaport Blvd Streetcapes
R79	Seaport Blvd Streetcapes
R80	Seaport Blvd Streetcapes
R81	Seaport Blvd Streetcapes
R82	Seaport Blvd Streetcapes
R83	Seaport Blvd Streetcapes
R84	Seaport Blvd Streetcapes
R85	Seaport Blvd Streetcapes
R86	Seaport Blvd Streetcapes
R87	Seaport Blvd Streetcapes
R88	Seaport Blvd Streetcapes
R89	Seaport Blvd Streetcapes
R90	Seaport Blvd Streetcapes
R91	Seaport Blvd Streetcapes
R92	Seaport Blvd Streetcapes
R93	Seaport Blvd Streetcapes
R94	Seaport Blvd Streetcapes
R95	Seaport Blvd Streetcapes
R96	Seaport Blvd Streetcapes
R97	Seaport Blvd Streetcapes
R98	Seaport Blvd Streetcapes
R99	Seaport Blvd Streetcapes
R100	Seaport Blvd Streetcapes

**FUTURE CUSTOMER SITES**

R01	New Giant Mills
R02	New Giant Mills
R03	New Giant Mills
R04	New Giant Mills
R05	New Giant Mills
R06	New Giant Mills
R07	New Giant Mills
R08	New Giant Mills
R09	New Giant Mills
R10	New Giant Mills
R11	New Giant Mills
R12	New Giant Mills
R13	New Giant Mills
R14	New Giant Mills
R15	New Giant Mills
R16	New Giant Mills
R17	New Giant Mills
R18	New Giant Mills
R19	New Giant Mills
R20	New Giant Mills
R21	New Giant Mills
R22	New Giant Mills
R23	New Giant Mills
R24	New Giant Mills
R25	New Giant Mills
R26	New Giant Mills
R27	New Giant Mills
R28	New Giant Mills
R29	New Giant Mills
R30	New Giant Mills
R31	New Giant Mills
R32	New Giant Mills
R33	New Giant Mills
R34	New Giant Mills
R35	New Giant Mills
R36	New Giant Mills
R37	New Giant Mills
R38	New Giant Mills
R39	New Giant Mills
R40	New Giant Mills
R41	New Giant Mills
R42	New Giant Mills
R43	New Giant Mills
R44	New Giant Mills
R45	New Giant Mills
R46	New Giant Mills
R47	New Giant Mills
R48	New Giant Mills
R49	New Giant Mills
R50	New Giant Mills
R51	New Giant Mills
R52	New Giant Mills
R53	New Giant Mills
R54	New Giant Mills
R55	New Giant Mills
R56	New Giant Mills
R57	New Giant Mills
R58	New Giant Mills
R59	New Giant Mills
R60	New Giant Mills
R61	New Giant Mills
R62	New Giant Mills
R63	New Giant Mills
R64	New Giant Mills
R65	New Giant Mills
R66	New Giant Mills
R67	New Giant Mills
R68	New Giant Mills
R69	New Giant Mills
R70	New Giant Mills
R71	New Giant Mills
R72	New Giant Mills
R73	New Giant Mills
R74	New Giant Mills
R75	New Giant Mills
R76	New Giant Mills
R77	New Giant Mills
R78	New Giant Mills
R79	New Giant Mills
R80	New Giant Mills
R81	New Giant Mills
R82	New Giant Mills
R83	New Giant Mills
R84	New Giant Mills
R85	New Giant Mills
R86	New Giant Mills
R87	New Giant Mills
R88	New Giant Mills
R89	New Giant Mills
R90	New Giant Mills
R91	New Giant Mills
R92	New Giant Mills
R93	New Giant Mills
R94	New Giant Mills
R95	New Giant Mills
R96	New Giant Mills
R97	New Giant Mills
R98	New Giant Mills
R99	New Giant Mills
R100	New Giant Mills

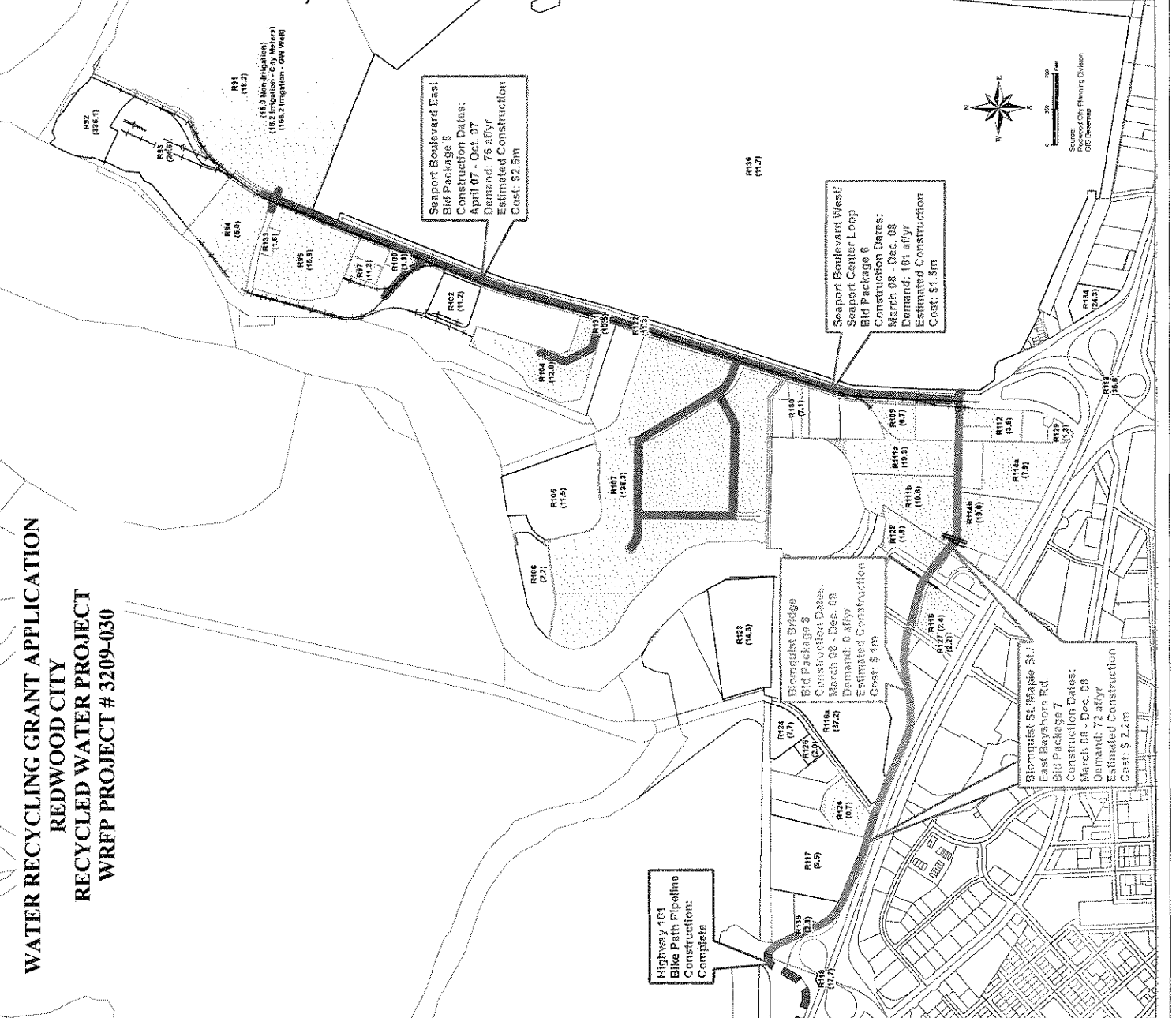

**LEGEND**

**Recycled Water Transmission System**  
 - Seaport Boulevard East  
 - Seaport Boulevard West/Seaport Center Loop  
 - Blomquist Bridge  
 - East Bayshore Rd./Blomquist St./Marble St.

**Potential Customers**  
 - Irrigation - Streetcapes & Commercial  
 - Non-Irrigation  
 - Existing or Future Customers

**Other Symbols**  
 - Highway 101 Bike Path Pipeline  
 - Customer Site I.D. Number and Demand (sf/yr)  
 - Roads  
 - Hwy - Hwy

Kennedy/Jenks Consultants  
 City of Redwood City, California

**SEAPORT/BAYFRONT  
 RECYCLED WATER PIPELINE SEGMENTS  
 AND POTENTIAL CUSTOMERS**

Project No: 04680  
 January 2006  
 Plate WRFP-06